

Andair LTD,
Unit 15 The Tanneries,
Havant, Hants, PO9 1JB
ENGLAND.

Tel +44(0) 2392 473 945
Fax +44(0) 2392 473 946
e-mail - info@andair.co.uk
web - www.andair.co.uk



PRODUCT - Duplex Valve FS20-20-D2

**SPEC SHEET
FS20-20-D2_{REV1}**

Duplex Fuel Selectors are valves that have two separate compartments so that two independent fuel lines can be switched simultaneously. This makes them ideal for fuel injected or diesel engines where there needs to be a return line. The great aspect of these valves is that the fuel can be returned to the same tank from which it was drawn, thus preventing dumping fuel overboard.

The FS20-20-D2 Duplex fuel selector is a 3/8" feed and return valve, between two fuel tanks (LEFT - RIGHT).

The Valve lever incorporates a safety feature where the red button has to be raised to switch the fuel to the OFF position. Inside the valve is a highly polished brass ball, packed with PTFE seal glands. This ensures a smooth and leak free operation.

The valve is available with alternative fittings (see sheet SPF20) and an extension (see sheet EX01).



Image shows FS20-20-D2-6F

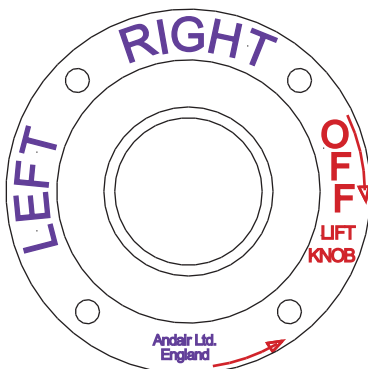
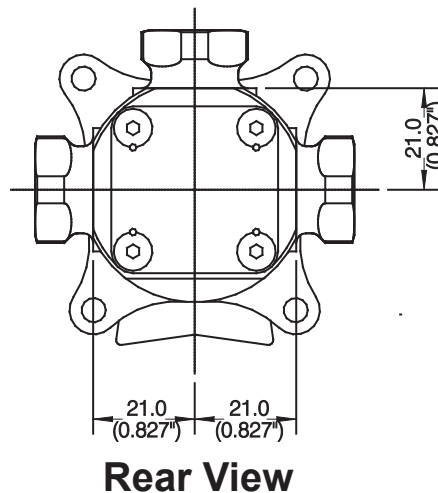
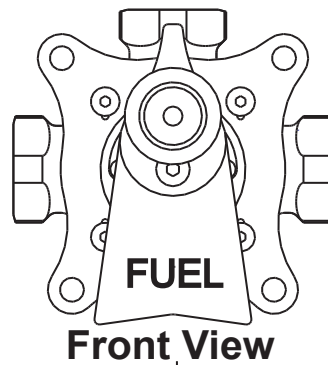
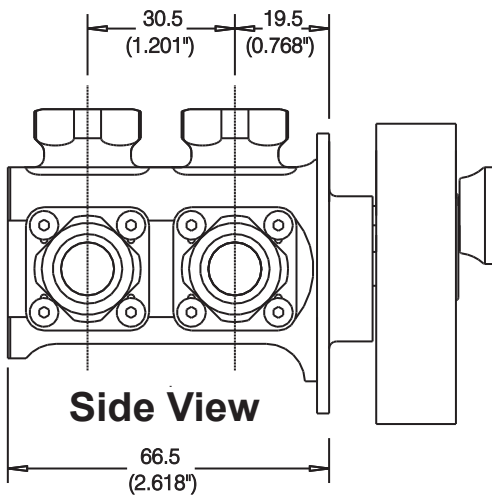

SPECIFICATION

Weight - 353g_(ex fittings).
Fittings - 6 x SP100.
Finish - Aluminium in contact with fuel, chromic anodised.
Red and Black, Sulphuric Anodised.
Diamond etched fascia plate.
Made from :
Body - Aluminium Alloy (L168)
Spindle - Brass (Cz121)
Ball seals - PTFE
'O' rings - Viton(R) 75
Satisfactory for all fuel types.