USER MANUAL

**MODEL NUMBER:
SP5.0L**

5 LITER PUMP UP SPRAY UNIT

English (Original Instructions)

READ ALL INSTRUCTIONS BEFORE OPERATING EQUIPMENT



Read this manual completely and understand the machine before operating or servicing it.

- Read all instructions before installing or operating unit.
- Always wear appropriate personal protective equipment (PPE) when operating or servicing unit.
- Always follow all chemical safety precautions and handling instructions provided by the chemical manufacturer and Safety Data Sheet (SDS).
- If this unit is modified or serviced with parts not listed in this manual, the unit may not operate correctly.
- Do not use unit if damaged or broken.
- Never point the discharge wand at yourself, another person, or any object you do not want covered in chemical.
- Always rinse and drain unit after use (as described in the After Use Instructions). Always store unit depressurized.
- Do not over-pressurize tank. Stop pumping if pressure relief valve activates.
- Only lift and carry unit by the carrying handle. Do not lift or carry the unit by the pump handle, hose, wand, or other components.
- Use only provided pump to pressurize unit. Pressurizing by any other means may create excessive pressure and cause unit to explode.
- Do not exceed maximum air or fluid pressure for unit (refer to Technical Data).
- Always flush the unit with fresh water thoroughly when switching from an alkaline to an acid or an acid to an alkaline.
- Do not modify or remove pressure relief valve. Do not use unit if pressure relief valve is not operational.
- Always depressurize unit before attempting to remove the pump assembly.

PROTECT THE ENVIRONMENT

Please dispose of packaging materials, old machine components, and hazardous fluids in an environmentally safe way according to local waste disposal regulations.



Always remember to recycle.

*Specifications and parts are subject to change without notice.

READ ALL INSTRUCTIONS BEFORE OPERATING EQUIPMENT

REQUIREMENTS	
Liquid temperature range	40-100°F (4.4-37°C)
Chemical compatibility	Chemical products used with this equipment must be formulated for this type of application and compatible with unit materials and pump seals. For more information on chemical compatibility, consult the manufacturer or SDS for your product or contact our customer service department.

SPECIFICATIONS	
Power type	Manual
Chemical pickup type	Draws from pre-mixed solution
Number of products unit can draw from	One product
Suction line length/diameter	11.5 in (29.2 cm) clear poly tubing with 1/8 in (0.3 cm) inner diameter
Capacity	1.3 gallons (5 liters)
Discharge line length/diameter	6.5 ft. (2 m) hose, with 1/4 in. (6.4 mm) inside diameter
Discharge wand/tip type	Polypropylene trigger handle with 17 in (43.2 cm) wand extension and 80° fan tip
Output distance	3-5 ft. (0.9-1.5 m)
Output volume	0.25 gal/min (0.9 l/min)
Flow rate*	0.25 gal/min (0.9 l/min)
Pump seals	Viton
Fluid fittings type	All-poly
Product height	17 in (2.5 cm)
Run time from full tank**	Approx. 5 min.

*Dilution rates and flow rates given are based on chemical with viscosity of water and factory air pressure settings.

**Area covered and run time may vary based on humidity, air flow, and product used.

READ ALL INSTRUCTIONS BEFORE OPERATING EQUIPMENT

Operation Instructions:

1. Remove all components from packaging.
2. Attach the lance assembly (LC-LLA-5.0L) to the trigger handle (LC-PSG-5.0L).
3. Confirm air pressure is completely released from unit by pulling the green pressure relief valve (LC-PRV) until the red part of the stem is revealed.
4. Securely hold the unit and unscrew the pump assembly (LC-PA) from the tank (TANK5.0L).
5. Follow all instructions from chemical manufacturer. Fill tank $\frac{3}{4}$ full with pre-mixed solution.
Note: Do not overfill tank with solution.
6. Securely hold the tank (TANK5.0L) and screw the pump assembly (LC-PA) in the tank head (LC-THA-SP5.0L).
7. Pressurize the tank by pumping up the unit until the pressure relief valve (LC-PRV) begins to leak air.
8. Once the desired pressure has been achieved, push the pump down (LC-PA) and twist it clockwise to lock it in place.
9. To start spraying, point the wand assembly at the area you wish to spray and squeeze the trigger handle to discharge solution.

After Use Instructions:

1. Release air pressure from unit after each use by pulling the green pressure relief valve (LC-PRV) until the red part of the stem is visible.
2. Empty all solution in tank and run fresh water through unit to rinse parts thoroughly.
3. Use tank handle (LC-HNDL-CLP) to carry unit, NOT pump assembly (LC-PA).

Maintenance Instructions:

Warning: Always depressurize unit before performing maintenance.

To keep your unit operating properly, periodically perform the following maintenance procedures:

- Check the pump assembly for wear and leaks.
- Check the suction tube and screen for debris and clean as needed.
- Periodically lubricate the pump seal with a food safe lubricant. To lubricate the pump seal, raise pump handle and apply 5 to 10 drops of food safe lubricant between pump and pump sleeve.

Note: NEVER USE LUBRICANTS SUCH AS WD40.

READ ALL INSTRUCTIONS BEFORE OPERATING EQUIPMENT

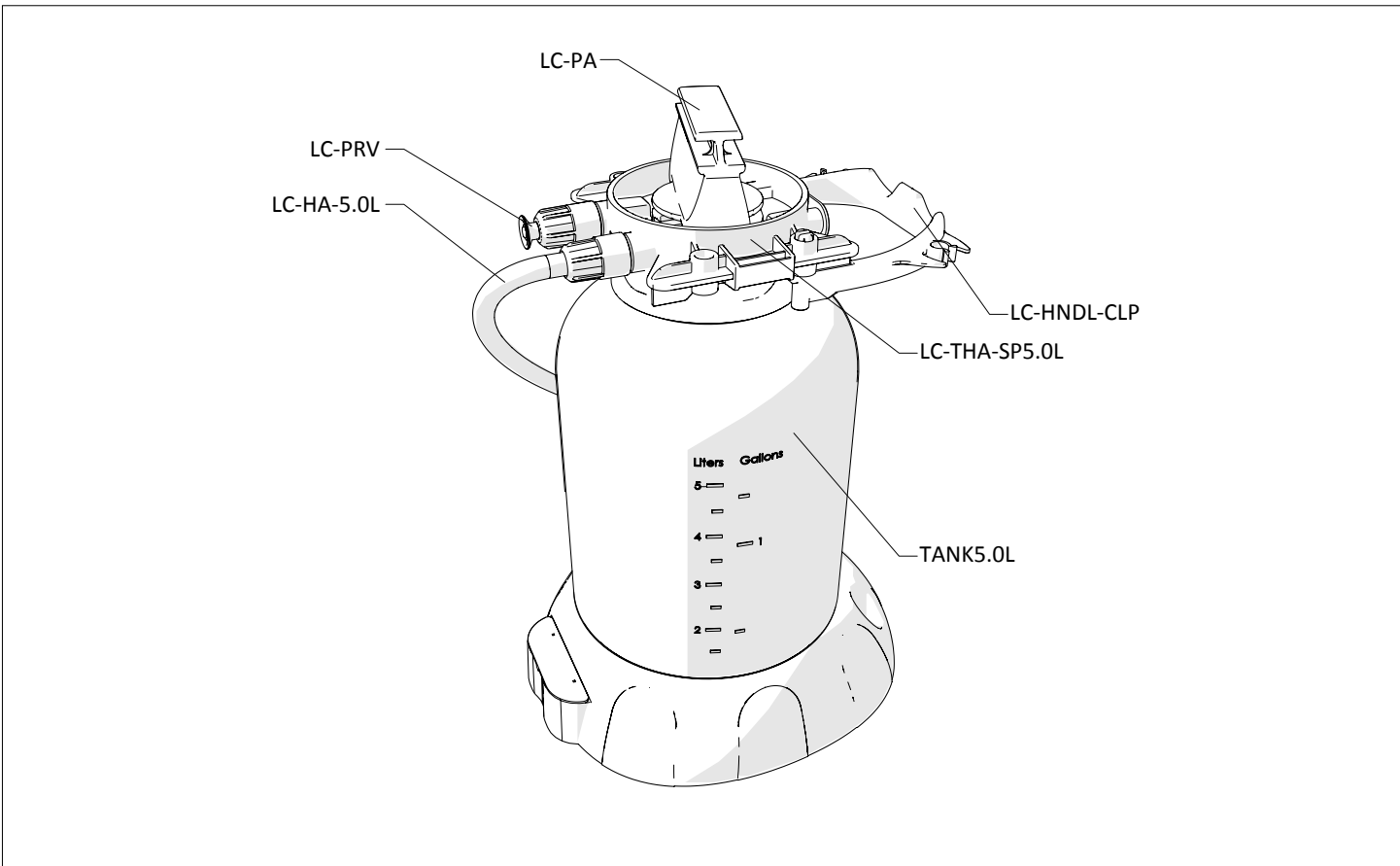

WAND ASSEMBLY ITEM NUMBER: LC-WA-SP5.0L

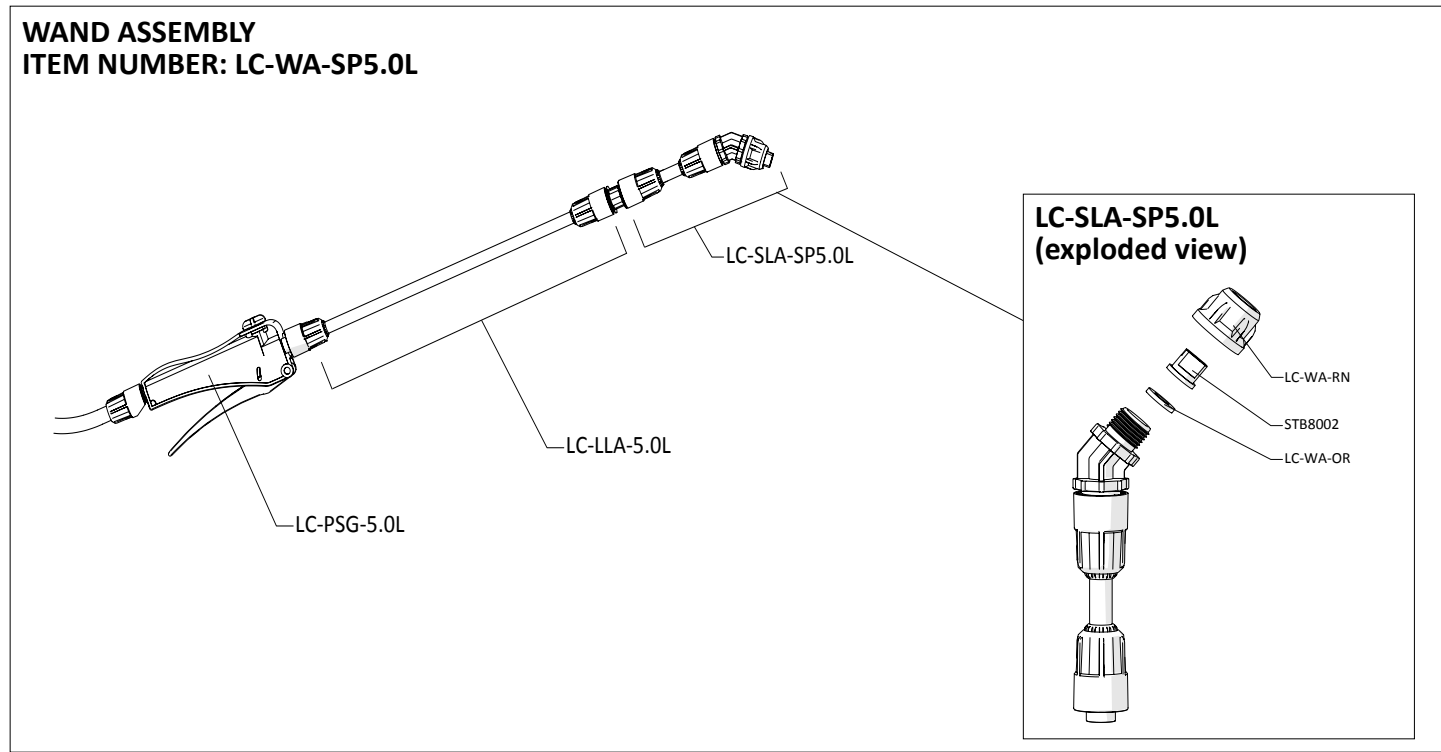

READ ALL INSTRUCTIONS BEFORE OPERATING EQUIPMENT

ITEM NUMBER	DESCRIPTION
LC-HA-5.0L	HOSE ASSEMBLY FOR 5L
LC-HNDL-CLP	TANK HANDLE FOR 5L/10L-WITH CLIPS
LC-LLA-5.0L	LONG LANCE (10 IN) ASSEMBLY FOR 5L-WITH RETAINING NUTS
LC-PA	MANUAL PUMP ASSEMBLY FOR 5L/10L-VITON
LC-PRV	PRESSURE RELIEF VALVE FOR 5L/10L
LC-PSG-5.0L	POLY SPRAY GUN FOR 5L-BLUE
LC-SLA-SP5.0L	SHORT LANCE (2 IN) ASSEMBLY FOR 5L SPRAY UNIT-WITH WADDING AND SPRAY TIP

ITEM NUMBER	DESCRIPTION
LC-THA-SP5.0L	TANK HEAD ASSEMBLY FOR 5L SPRAY UNIT-WITH PRESSURE RELIEF VALVE AND TANK HANDLE
LC-WA-OR	ORING IN 1.5L/5L WAND
LC-WA-RN	RETAINING NUT FOR 1.5L/5L WAND ASSEMBLY
STB8002	SPRAY TIP-BUTTON STYLE-80 DEGREE-0.2 GPM
TANK5.0L	5 LITER TANK