

Configuration			
Dash #	Assy, Probe	Envelope	Sensor Type
-1	9019592-1	7014772-12	RTD
-2	9019592-2	7014772-13	Current

Revision				
ECO	Rev	Description	Date	Approved
	A	Production release.	02/16/21	VAA/Sch

Temp (°F)	B-11-1 (RTD)		B-11-2 (Current)	
	Resistance (Ohms)	Tolerance (±°F)	Amps (µA)	Tolerance (±°F)
0	465.2	0.7	255.4	4.5
40	508.7	0.7	277.6	4.5
80	551.9	0.7	299.8	4.5

B-11-1		B-11-2	
Wire Color	Signal	Wire Color	Signal
Black	Pin 1 of RTD	Red	Power
Black	Pin 2 of RTD	Black	Return

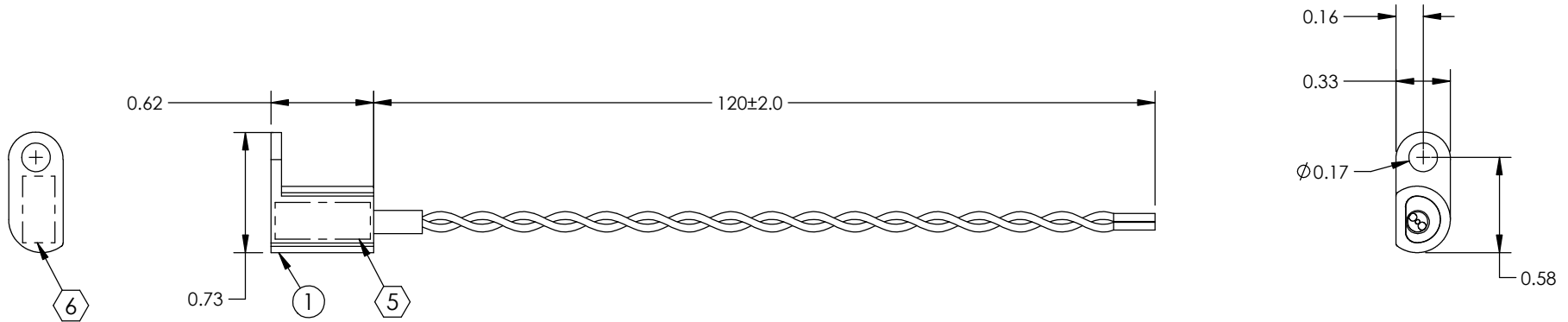

Item	Qty	Part Number	Description
1	1	See Config	Assy, Probe, B-11
2	1	90-806-00000	Screw 8-32X3/16 Pan Phil SS (Not Shown)
3	1	90-608-00011	Screw 6-32X1/4 Pan Phil Blk Patch (Not Shown)
4	1	9016794	Tie, Cable, 4" (Not Shown)
5	1	See Config	Envelope, Printed, B-11 (Not Shown)

Note:

- Internal connections are hermetically potted and sealed against moisture and contamination.
- 1 configuration only based upon IEC60751, Class B.
- Serial numbers to be completed accordingly on each unit.
- Temperature rating: -58°F to +311°F (-50°C to +155°C).
- Serial numbers to be completed accordingly on each unit.
- Model number to be stamped or scribed on to each unit.
- Weight: 1 oz

UNLESS OTHERWISE SPECIFIED, ALL DIMENSIONS ARE IN INCHES.
 TOLERANCE:
 .X= ±0.065
 .XX= ±0.015
 .XXX= ±0.005
 .XXXX= ±0.002
 ANGULAR= ±0.5°
 WEIGHT N.T.E. +5%
 BREAK ALL SHARP EDGES
 THREADS PER MIL-S-7742

DRAWN:
 VAA
 02/16/21

APPROVED:
 Sch
 03/22/2021

This document discloses proprietary information of Mid-Continent Instrument Co., Inc. It may be reproduced or disclosed only with written permission of Mid-Continent Instrument Co. and is not to be used in any way detrimental to the interests of Mid-Continent Instrument Co., Inc.

MidContinent[®]
 INSTRUMENTS+AVIONICS

TITLE:
 Probe, Cabin Temperature

PART NUMBER:
 B-11

SCALE: 1:1

DO NOT SCALE THIS DRAWING

SHEET: 1 of 1