

# BEARINGS

## ROD ENDS FEMALE THREADED (F & HF SERIES)

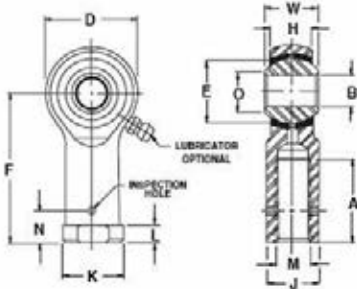

### SPECIFICATIONS:

**Outer Member:** Aircraft Quality Steel, Cadmium Plated.

**Ball:** SAE 52100 Steel.

**Inserts:** Naval Bronze

"L" in rod end number designates left hand thread. Add suffix "G" to indicate lubricator is required. Example: F35-14G. Add suffix "FG" to indicate flush type lubricator is required. Example: HF-4FG. Add \$3.00 to price for lubricator (G) (FG).

**Note: Standard Bearings Furnished Without Inspection Hole. If Hole Needed, Add "M" to P/N & At Higher Cost.**



Part No.	Bore	Ball Width	Housing Width	Head Dia.	Length to ctr. of ball	Thread Length	Thread Size	Ball Dia.	Ball Flat Dia.	Other Dimensions			Max Rad. Load	Weight	Price
	B	W	H	D	F	A	M	E	O	K	N	L			
	+0.015 -0.005	+0.000 -0.005	+0.005 -0.005	+0.010 -0.010	+0.010 -0.010	+0.062 -0.031	UNF-3B	REF	REF	+0.010 -0.010	+0.020 -0.020	+0.010 -0.010			
FL34-14M	.1900	.437	.328	.750	1.375	.750	.2500-28	.515	.273	.468	.312	.187	2850	.06	---
F34-14M	.1900	.437	.328	.750	1.375	.750	.2500-28	.515	.273	.468	.312	.187	2850	.06	---
F347-14M	.1900	.437	.328	.750	1.062	.437	.2500-28	.515	.273	.375	-	-	2850	.05	---
F34-16G	.1900	.437	.375	.812	1.375	.750	.2500-28	.593	.321	.468	.312	.187	2750	.08	---
F34-16M	.1900	.500	.375	.812	1.375	.750	.2500-28	.593	.321	.468	.312	.187	2750	.08	---
F35-14M	.1900	.437	.328	.750	1.375	.750	.3125-24	.515	.0273	.500	.406	.187	2850	.07	---
FL35-14M	.1900	.437	.328	.750	1.375	.750	.3125-24	.515	.273	.500	.406	.187	2850	.07	---
F44-14M	.2500	.437	.304	.812	1.375	.750	.2500-28	.562	.354	.468	.312	.187	2850	.07	---
FL44-14M	.2500	.437	.304	.812	1.375	.750	.2500-28	.562	.354	.468	.312	.187	2850	.07	---
F45-19M	.250	.593	.438	.938	1.469	.750	.3125-24	.687	.347	.500	.406	.187	3700	.11	---
HF-3M	.1900	.312	.250	.625	1.062	.562	.1900-32	.437	.306	.406	-	.187	1850	.03	---
HFL-3M	.1900	.312	.250	.625	1.062	.562	.1900-32	.437	.306	.406	-	.187	1850	.03	---
HF-4M	.2500	.375	.281	.750	1.312	.750	.2500-28	.515	.353	.468	-	.187	2700	.05	---
HFL-4M	.2500	.375	.281	.750	1.312	.750	.2500-28	.515	.353	.468	-	.187	2700	.05	---
HF-5M	.3125	.437	.344	.875	1.375	.750	.3125-24	.625	.447	.500	-	.187	3350	.08	---
HFL-5M	.3125	.437	.344	.875	1.375	.750	.3125-24	.625	.447	.500	-	.187	3350	.08	---
HFL-2A	.1562	.281	.219	.562	.875	.375	.1640-32	-	.249	-	-	-	1700	.02	---

New Surplus HFL-3M Bearing.....P/N 04-03454  
 New Surplus HFX-5G Bearing.....P/N 04-03452  
 New Surplus HFX-8G Bearing.....P/N 04-03453

\*F34-14 Dimensionally the same as Fafnir REPB3N. \*\*F35-14 Dimensionally the same as Fafnir REPB3N2

## SEALS-IT ROD END SEALS



Protect the spherical bearing of rod ends. This patented design features a neoprene rubber seal bonded directly to an aircraft quality washer. The seal encapsulates the bearing and flexes accordingly with any change in angularity. This provides unprecedented protection from dirt and other types of contamination which may severely shorten the life of these important components.

The rubber is engineered for wide range of temperature variation and is impervious to gasoline, oils, and most other common fluids. The steel washer is plated for protection from corrosion.

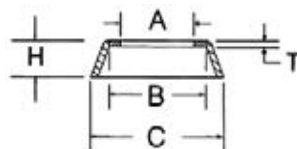

Size	A	B	C	H	T	Part No.	Price
3/16	.200	.326	.442	.096	.020	05-01434	---
1/4	.257	.375	.565	.125	.025	05-2500	---
5/16	.325	.450	.710	.200	.047	05-3125	---
3/8	.386	.525	.775	.220	.047	05-3750	---
7/16	.445	.610	.910	.250	.047	05-4375	---
1/2	.515	.710	1.125	.250	.047	05-5001	---
5/8	.638	.900	1.250	.250	.047	05-6250	---
3/4	.763	1.00	1.375	.375	.047	05-7500	---

